

ACTUAL SIZE

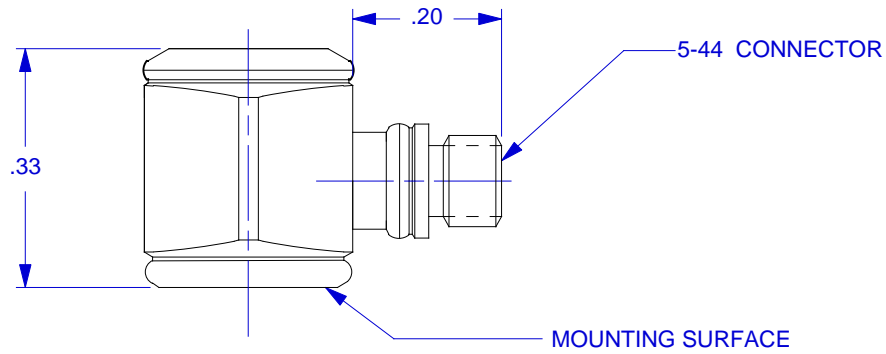

1. WEIGHT: 2.3 GRAMS.

		CHATSORTH, CA.					
SCALE	4X	REV	-	DATE	-	ECN	-
DATE	2/10/00	PART NO.			MODEL 3035CG		
DRAWN	N.C.	CHECKED	R.A.	MAT'L			
APPROVED			NEXT ASSEMBLY		USED ON		
TITLE						DWG NO.	
OUTLINE/INSTALLATION DRAWING, MODEL 3035CG CHARGE MODE ACCELEROMETER						127-3035CG	
						SHEET 1 OF 1	

SPECIFICATIONS
MODEL 3035CG CHARGE MODE ACCELEROMETER

SPECIFICATION	VALUE	UNITS
PHYSICAL		
WEIGHT	2.3	Grams
SIZE, HEX X HEIGHT	.281 (9/32) X .33	Inches
MOUNTING PROVISION	adhesive mount	
CONNECTOR, RADIALY MOUNTED	5-44	Coaxial
MATERIAL, HOUSING AND CONNECTOR	300 Series	Stainless Steel
PERFORMANCE		
SENSITIVITY, NOM.[1]	2.5	pC/G
RANGE F.S.	± 500	G's
FREQUENCY RANGE, ± 5%	0.5 to 10k	Hz
RESONANT FREQUENCY, NOM.	45	kHz
LINEARITY [2]	± 1%	% F.S.
TRANSVERSE SENSITIVITY, MAX.	5	%
STRAIN SENSITIVITY	.002	G's/μ @ 250 μ
ENVIRONMENTAL		
MAXIMUM VIBRATION/SHOCK	600/3000	± G's/G's PEAK
TEMPERATURE RANGE	-100 to +400	°F
SEAL, HERMETIC	Glass-to-metal and TIG welded	
COEFFICIENT OF THERMAL SENSITIVITY	.03	%/°F
ELECTRICAL		
CAPACITANCE, NOM.	630	pF
OUTPUT SIGNAL POLARITY FOR ACCELERATION TOWARD TOP		Negative
CASE GROUNDING	Case is grounded to electrical power ground	

[1] Measured at 100 Hz, 1 G RMS per ISA RP 37.2.

[2] Measured using zero-based best straight-line method, % of F.S. or any lesser range.