

PORT PREPARATION INSTRUCTIONS:

DRILL 5/8 (.625 +.005/-0.00) DIA, THRU
COUNTER BORE, 45/64 (Ø.708 +.003/-0.00) x .460 DEEP
TAP 3/4-16, UNF-2B x .300 MINIMUM DEPTH

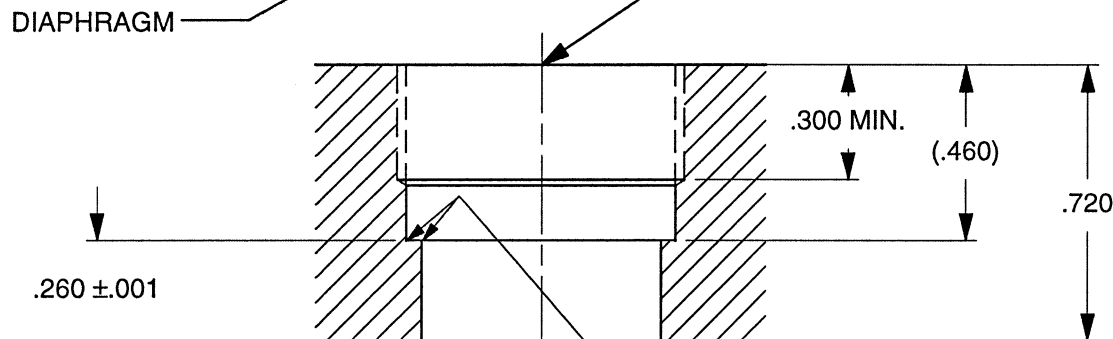

THESE CORNERS SHARP TO .003 MAX RADIUS

4. BODY/DIAPHRAGM MATERIAL, TITANIUM ALLOY.
3. WEIGHT, LESS CLAMP NUT-35 GRAMS
2. TORQUE ON 6230 CLAMP NUT: 20 LB-IN.
1. THESE DIAMETERS MUST BE CONCENTRIC TO .003 TIR.

DYTRAN INSTRUMENTS, INC.		CHATSWORTH, CA.	
SCALE 2X	REV	DATE	ECN
DATE 6/29/07	PART NO. MODELS 2013D & 2013M10		
DRAWN N.C.	CHECKED	MAT'L	
APPROVED <i>7-307</i>	NEXT ASSEMBLY		USED ON MODELS 2013D & 2013M10
TITLE OUTLINE/INSTALLATION DRAWING MODELS 2013D & 2013M10			DWG NO. 127-2013D
SHEET 1 OF 1			



SPECIFICATIONS, MODEL 2013D HIGH SENSITIVITY MICROPHONE

SPECIFICATION	VALUE	UNITS
PHYSICAL		
WEIGHT, INCLUDES ADAPTOR & HOLLOW CLAMP NUT	35	GRAMS
SIZE (BODY DIA x HEIGHT)	.615 x 1.47	INCHES
MOUNTING PROVISION	HOLLOW CLAMP NUT	3/4-16 THD.
CONNECTOR, COAXIAL, AXIALLY MOUNTED	10-32, UNF-2A	
BODY/CONNECTOR MATERIAL	TITANIUM	
DIAPHRAGM MATERIAL	TITANIUM	
PERFORMANCE		
SENSITIVITY, NOM. [1]	2.00	V/Psi
RANGE F.S. FOR 5 VOLTS RMS OUT	2.5 (185)	Psi (db)
ABSOLUTE MAXIMUM PRESSURE	20 (196)	Psi (db)
EQUIVALENT ELECTRICAL NOISE (RESOLUTION)	2.5×10^{-5} (74)	Psi (db)
MOUNTED RESONANT FREQUENCY, NOM.	50	kHz
FREQUENCY RESPONSE, $\pm 5\%$	5	kHz
MINIMUM RISE TIME OF INPUT PULSE OR STEP	5	μ Sec
DISCHARGE TIME CONSTANT, MIN.	0.4	Sec
LOWER -3db FREQUENCY	0.4	Hz
LOWER -5% FREQUENCY	1.2	Hz
NON-LINEARITY (ZERO BASED BEST FIT ST. LINE METHOD) [2]	1.0	% F.S., MAX.
ACCELERATION SENSITIVITY, AXIAL DIRECTION	.002	Psi/G
ENVIRONMENTAL		
MAXIMUM VIBRATION	± 300	G's, RMS
MAXIMUM SHOCK	500	G's, PEAK
TEMPERATURE RANGE	-60 TO +300	$^{\circ}$ F
MAXIMUM DIAPHRAGM FLASH TEMPERATURE, SHORT DURATION	3000	$^{\circ}$ F
THERMAL COEFFICIENT OF SENSITIVITY	0.03	%/ $^{\circ}$ F
SEAL	HERMETIC	WELDED/GLASS TO METAL
ELECTRICAL		
EXCITATION (COMPLIANCE) VOLTAGE RANGE [3]	+20 to +30	VDC
EXCITATION CURRENT RANGE [3]	2 to 20	mA
OUTPUT IMPEDANCE, NOM.	150	OHMS
OUTPUT BIAS VOLTAGE, NOM.	11.5	VDC
OUTPUT SIGNAL POLARITY FOR INCREASING PRESSURE	POSITIVE GOING	

SUPPLIED ACCESSORIES:

ONE MODEL 6230 HOLLOW CLAMP NUT
TWO [2] MODEL 6607B BRASS SEALS

NOTES:

- [1] 0 db REFERENCE: .0002 DYNES PER CM²
- [2] PERCENT FULL SCALE, ZERO-BASED BEST FIT STRAIGHT LINE METHOD.
- [3] FROM CONSTANT CURRENT TYPE POWER UNIT ONLY. THIS SENSOR MUST NOT BE CONNECTED TO A DC POWER SOURCE WITHOUT CURRENT LIMITING, 20 mA MAXIMUM.
- [4] A CALIBRATION CERTIFICATE TRACEABLE TO NIST IS SUPPLIED WITH EACH INSTRUMENT.