

**PROPRIETARY AND CONFIDENTIAL**

THE INFORMATION CONTAINED IN THIS DRAWING IS THE SOLE PROPERTY OF DYTRAN INSTRUMENTS INC. ANY REPRODUCTION IN PART OR AS A WHOLE WITHOUT THE WRITTEN PERMISSION OF DYTRAN INSTRUMENTS INC IS PROHIBITED.

REVISIONS					
REV.	ECN	DESCRIPTION	BY/DATE	CHK	APPR
A	5112	INITIAL RELEASE	03/07/08	CES	PML
B	5263	REVISED POLARITY MARKING	JS 06/05/08	RA	DV
C	5630	ADDED X,Y,Z ARROWS	JS 12/01/08	RA	DV

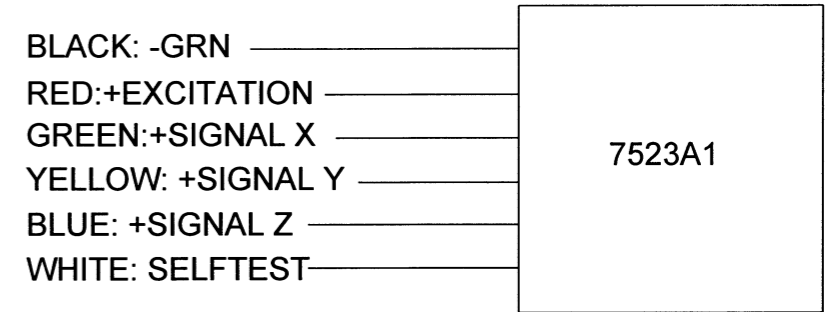
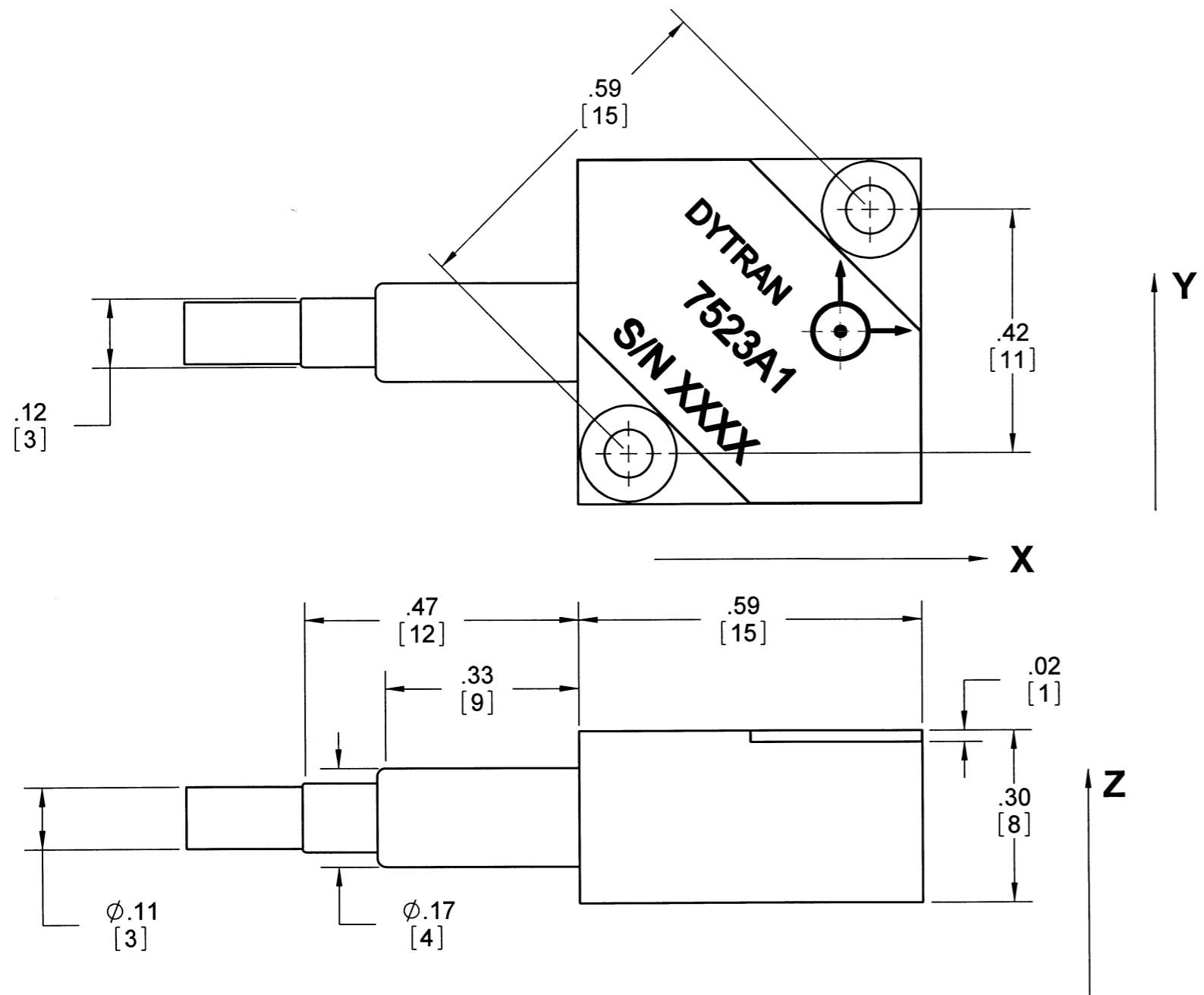

WIRING DIAGRAM

DRILL HOLE SIZE	TOLERANCE	UNLESS OTHERWISE SPECIFIED: INTERPRET DIM & TOL PER ASME Y14.5M - 1994. REMOVE BURRS. COUNTERSINK INTERNAL THDS 90° TO MAJOR DIA. CHAM EXT THDS 45° TO MINOR DIA. THD LENGTHS AND DEPTHS ARE FOR MIN FULL THDS. THDS PER MIL-S-7742. DIMENSIONS APPLY AFTER FINISHING
.0135 THRU .125	+0.004 / -.001	ALL MACHINED SURFACES $\sqrt{63}$ TOTAL RUNOUT WITHIN .005. BREAK SHARP EDGES .005 TO .010. MACHINED FILLET RADII .005 TO .015. WELDING SYMBOLS PER AWS A2.4. ABBREVIATIONS PER MIL-STD-12.
.1260 THRU .250	+0.005 / -.001	
.2510 THRU .500	+0.006 / -.001	
.5010 THRU .750	+0.008 / -.001	
.7510 THRU 1.000	+0.010 / -.001	
1.001 THRU 2.000	+0.012 / -.001	

THIRD ANGLE PROJECTION  
USA

UNLESS OTHERWISE SPECIFIED: DIMENSIONS ARE IN INCHES. TOLERANCES ARE: DECIMALS .XX ± .010 ANGLES ± 1°. .XXX ± .005	CONTRACT NO.	
MATERIAL: ALUMINUM ALLOY	APPROVALS	DATE
FINISH:	ORIG PML	10/18/07
DO NOT SCALE DRAWING	CHK CES	03/19/08
	APP PML	03/21/08
	APP	

**DYTRAN INSTRUMENTS, INC.** Chatsworth, CA

**MASTER ONLY IF IN RED**

TITLE: **DC ACCELEROMETER, TRIAXIAL, 2g**

SIZE <b>B</b>	CAGE CODE <b>2W033</b>	DWG NO <b>127-7523A1</b>	REV <b>C</b>
---------------	------------------------	--------------------------	--------------

SCALE: 4:1      SOLIDWORKS      SHEET 1 of 1



## SPECIFICATIONS, SERIES 7523A TRIAXIAL ACCELEROMETER

### PERFORMANCE

	A1	A3	A5	UNITS
Input	±2	±1	±50	g
Output, bias, ±20%	2.5	2.5	2.5	V
Output range	±1.1	±1.4	±1.8	V
Bandwidth, X & Y Axes	0-1500	0-1500	0-400	Hz
Z Axis	0-500	0-1500	0-400	Hz
Sensitivity	550	93	36	mV/g
Output Noise, nom.	3	10	40	mGrms
Output Impedance	3500	3500	<500	Ω

### PERFORMANCE FOR ALL MODEL NUMBERS (Tc=+25°C)

	MIN	NOM	MAX	UNITS
Maximum Mechanical Shock			4000	g peak
Resonance Frequency		5000		Hz
Transverse Sensitivity			2	%
Operating Temperature	-55		+125	°C
Compensated Temperature Range (CTR)	-20		+70	°C
Thermal Zero in CTR			0.03	% FS/°C
Thermal Sensitivity Drift in CTR			0.02	% FS/°C
Storage Temperature	-55		-150	°C
Non-Linearity			0.3	%
Excitation, regulated	4.8		5.2	VDC
Current consumption		4.5		mA

### PHYSICAL PARAMETERS FOR ALL MODEL NUMBERS

Case Material	anodized aluminum			
Cable Length	A1	A3	A5	UNITS
	79	77	79	inch
Mounting Provision	two M2 screws (provided)			

	MIN	NOM		MAX	UNITS
	A1	A3	A5		
Case Length			0.59		inch
Case Width			0.59		inch
Case Height	0.30	0.30	0.59		inch
Mounting Hole Spacing			0.59		inch
Mass				10	grams

### NOTES:

### SUPPLIED ACCESSORIES:

A1 (2) Mounting Screws (Model 6722), M2 x 12 flathead  
 A3, A5 (2) Mounting Screws (Model 6914), M2 x 20 flathead